



Presentation for

Nashua Middle School Staff Presentation

Architectural Design Services for
Middle School Construction
and/or Renovations

Nashua, New Hampshire

October 21, 2019



1. Objectives and Goals
2. Facility Analysis Overview
3. Programming Overview
4. Concept Design Overview



AGENDA

1. Address Deficiencies at Elm Street School
 - Option 1-Renovate Elm Street
 - Option 2-New Middle School
2. Review of Facility Conditions at all 3 Middle Schools
3. Evaluate a model for (3) 800+ Student Middle Schools
 - Special Education Spaces
 - Middle School Team Areas
 - Unified Arts
 - Safety and Security
 - Athletic/Phys Ed/Recreation Facilities
 - Core Space Capacity (Library, Cafeteria)
 - Site Circulation (Parent/Bus Drop-off, Parking)

.....
OBJECTIVES and GOALS

“Building a diverse learning community by encouraging students to open their eyes to explore, their minds to create, and their hearts to accept.”

FACILITY

“Building a diverse learning community by encouraging students to open their eyes to explore, their minds to create, and their hearts to accept.”

BUILDING | SITE FACILITY ANALYSIS PROCESS



FACILITY

.....
EXISTING FACILITY ANALYSIS
SUMMARY OF THE PROCESS

“Building a diverse learning community by encouraging students to open their eyes to explore, their minds to create, and their hearts to accept.”

BUILDING | SITE COMPONENT DEFICIENCIES

ELM STREET MIDDLE SCHOOL

- Portable Classrooms
- No Athletic Fields
- Inadequate Parking
- Traffic And Pedestrian Safety Issues
- Accessibility Limited Throughout Building
- Aged Heating System & Poor Ventilation
- Classroom Electrical Capacity Limited



Family & Consumer Science – laminate edge peeled off, counter height not ADA compliant

BUILDING | SITE COMPONENT DEFICIENCIES

FAIRGROUNDS MIDDLE SCHOOL

- Pedestrian Site Safety Issues
- Exterior Doors & Frames Rusted Through
- Accessibility Limited In Some Spaces
- Aged Power Distribution System
- Classroom Electrical Capacity Limited
- Access Control Limited



BUILDING | SITE COMPONENT DEFICIENCIES

PENNICHUCK MIDDLE SCHOOL

- Portable Classrooms
- Exterior Door And Frames Rusted Through
- Interior Finishes & Folding Partition
- Accessibility Limited In Some Spaces
- Aged Mechanical Units
- Access Control Limited
- Intercom Systems is Outdated



Folding partition



Packaged RTU in poor condition



PROGRAM

“Building a diverse learning community by encouraging students to open their eyes to explore, their minds to create, and their hearts to accept.”

PROGRAMMING PROCESS



PROGRAM

.....
EDUCATION/PROGRAM NEEDS ASSESSMENT
SUMMARY OF THE PROCESS

“Building a diverse learning community by encouraging students to open their eyes to explore, their minds to create, and their hearts to accept.”

SPACE ALLOCATION SUMMARY / EXISTING CONDITIONS				
	Elm Street Middle School	Fairgrounds Middle School	Pennichuck Middle School	Subtotal
FULL SIZE CLASSROOMS	48	32	28	108
SPECIAL EDUCATION (SPED)				
SPED Self Contained (Intensive Needs)	0	2	1	3
SPED District Programs	10	3	1	14
Intervention (Resource)	4	6	4	14
SPED Rooms	4	2	6	12
OT / PT	1	1	1	3
Speech	1	0	1	2
ELL	2	1	1	4
UNIFIED ARTS				
Robotics / STEM	1	1	0	2
Industrial Arts / Woodworking	1	2	2	5
Family Consumer Science (FCS)	2	2	2	6
Band	1	1	1	3
Chorus / Keyboard	1	1	1	3
Computer	4	1	1	6
Art	2	2	2	6
World Language	2	2	2	6
Drafting / Engineering	1	0	1	2
TEAM COLLABORATION	0	3	0	3
HEALTH CLASSROOM	1	0	0	1
CAPACITY				
Regular Education Classrooms (excludes SPED spaces)	48	32	28	108
Capacity (22-25)	1,056	768	644	2,468
SPED Capacity	140	70	80	290
Total Capacity	1,196	838	724	2,758
Current Enrollment	1,093	695	627	2,415
DELTA	103	143	97	343

PROGRAM

EDUCATION/PROGRAM NEEDS ASSESSMENT SUMMARY OF EXISTING SPACES

“Building a diverse learning community by encouraging students to open their eyes to explore, their minds to create, and their hearts to accept.”

SUMMARY OF EXISTING SPACE UTILIZATION

	Elm Street Middle School	Fairgrounds Middle School	Pennichuck Middle School	Subtotals
Calculated Capacity				
Full Size Education Classrooms (Excludes SPED spaces)	48	32	28	108
Capacity (Using 22-25 students/classroom)	1,056	768	644	2,468
SPED Classroom	140	70	80	290
Total Calculated Capacity	1,196	838	724	2,758
Current Enrollment	1,093	695	627	2,415
Delta (Additional Capacity)	103	143	97	343

PROGRAM

EDUCATION/PROGRAM NEEDS ASSESSMENT
 SUMMARY OF EXISTING SPACE UTILIZATION

“Building a diverse learning community by encouraging students to open their eyes to explore, their minds to create, and their hearts to accept.”

PROPOSED OPTION #1 SUMMARY

ELM STREET MIDDLE SCHOOL RENOVATIONS AND ADDITIONS



FAIRGROUNDS MIDDLE SCHOOL RENOVATIONS AND ADDITION



PENNICHUCK MIDDLE SCHOOL RENOVATIONS AND ADDITIONS

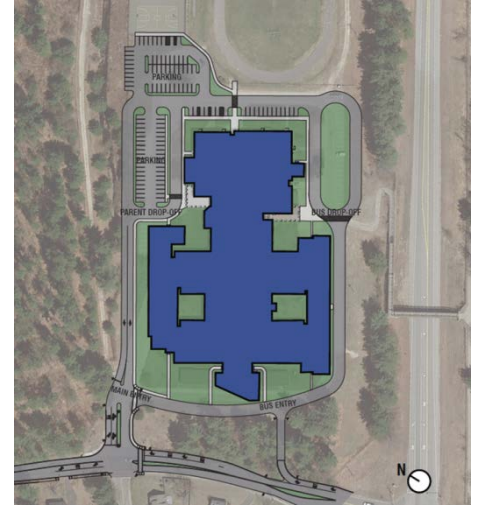

PROGRAM

EDUCATION/PROGRAM NEEDS ASSESSMENT OPTION #1 SUMMARY

"Building a diverse learning community by encouraging students to open their eyes to explore, their minds to create, and their hearts to accept."

SPACE ALLOCATION SUMMARY / PROPOSED OPTION #1				
	Elm Street Middle School	Fairgrounds Middle School	Pennichuck Middle School	Subtotal
FULL SIZE CLASSROOMS	33	32	36	101
SPECIAL EDUCATION (SPED)				
SPED Self Contained (Intensive Needs)	3	0	0	3
SPED District Programs	14	0	0	14
Intervention (Resource)	4	6	7	17
SPED Rooms	4	5	6	15
OT / PT	1	1	1	3
Speech	1	1	1	3
ELL	1	1	1	3
UNIFIED ARTS				0
Robotics / STEM	1	1	1	3
Industrial Arts / Woodworking	1	1	1	3
Family Consumer Science (FCS)	2	2	2	6
Band	1	1	1	3
Chorus / Keyboard	1	1	1	3
Computer	1	1	1	3
Art	2	2	2	6
World Language	2	2	2	6
Drafting / Engineering	0	0	0	0
TEAM COLLABORATION	9	3	4	16
HEALTH CLASSROOM	1	1	1	3
CAPACITY				
Regular Education Classrooms (excludes SPED spaces)	33	32	36	101
Capacity (22-25)	825	768	828	2,421
SPED Capacity	210	50	60	320
Total Calculated Capacity	1,035	818	888	2,741
Current Enrollment	815	800	800	2,415
DELTA	220	18	88	326

PROGRAM

EDUCATION/PROGRAM NEEDS ASSESSMENT SUMMARY OF PROPOSED SPACES

“Building a diverse learning community by encouraging students to open their eyes to explore, their minds to create, and their hearts to accept.”

SUMMARY OF PROPOSED OPTION #1 SPACE UTILIZATION

	Elm Street Middle School	Fairgrounds Middle School	Pennichuck Middle School	Subtotals
Calculated Capacity				
Full Size Education Classrooms (Excludes SPED spaces)	33	32	36	101
Capacity (Using 22-25 students/classroom)	825	768	828	2,421
SPED Classroom	210	50	60	320
Total Calculated Capacity	1,035	818	888	2,741
Proposed Enrollments	815	800	800	2,415
Delta (Additional Capacity)	220	18	88	326

PROGRAM

EDUCATION/PROGRAM NEEDS ASSESSMENT
 SUMMARY OF PROPOSED SPACE UTILIZATION

“Building a diverse learning community by encouraging students to open their eyes to explore, their minds to create, and their hearts to accept.”

PROPOSED OPTION #2 SUMMARY

NEW MIDDLE SCHOOL

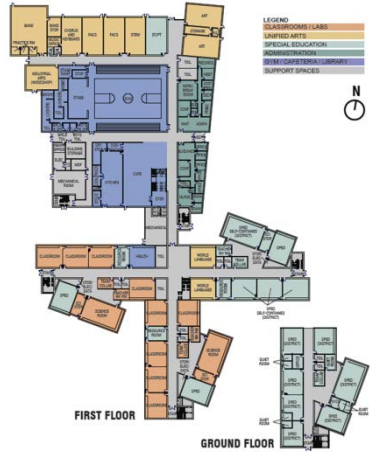

FAIRGROUNDS MIDDLE SCHOOL RENOVATIONS AND ADDITION



PENNICHUCK MIDDLE SCHOOL RENOVATIONS AND ADDITIONS

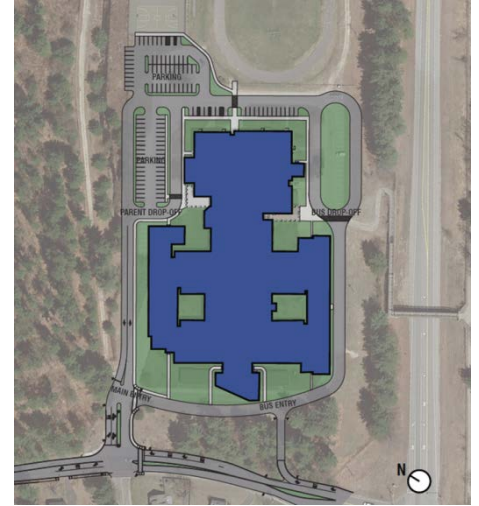

EDUCATION/PROGRAM NEEDS ASSESSMENT OPTION #2 SUMMARY

PROGRAM

"Building a diverse learning community by encouraging students to open their eyes to explore, their minds to create, and their hearts to accept."

SPACE ALLOCATION SUMMARY / PROPOSED OPTION #2				
	New Nashua Middle School	Fairgrounds Middle School	Pennichuck Middle School	Subtotal
FULL SIZE CLASSROOMS	34	32	36	102
SPECIAL EDUCATION (SPED)				
SPED Self Contained (Intensive Needs)	4	0	0	4
SPED District Programs	14	0	0	14
Intervention (Resource)	6	6	7	19
SPED Rooms	6	5	6	17
OT / PT	1	1	1	3
Speech	1	1	1	3
ELL	1	1	1	3
UNIFIED ARTS				0
Robotics / STEM	1	1	1	3
Industrial Arts / Woodworking	1	1	1	3
Family Consumer Science (FCS)	2	2	2	6
Band	1	1	1	3
Chorus / Keyboard	1	1	1	3
Computer	1	1	1	3
Art	2	2	2	6
World Language	2	2	2	6
Drafting / Engineering	0	0	0	0
TEAM COLLABORATION	9	3	4	16
HEALTH CLASSROOM	1	1	1	3
CAPACITY				
Regular Education Classrooms (excludes SPED spaces)	34	32	36	102
Capacity (22-25)	850	768	828	2,446
SPED Capacity	240	30	60	330
Total Calculated Capacity	1,090	798	888	2,776
Current Enrollment	815	800	800	2,415
DELTA	275	-2	88	361

PROGRAM

EDUCATION/PROGRAM NEEDS ASSESSMENT SUMMARY OF PROPOSED SPACES

“Building a diverse learning community by encouraging students to open their eyes to explore, their minds to create, and their hearts to accept.”

SUMMARY OF PROPOSED OPTION #2 SPACE UTILIZATION

	New Middle School	Fairgrounds Middle School	Pennichuck Middle School	Subtotals
Calculated Capacity				
Full Size Education Classrooms (Excludes SPED spaces)	34	32	36	102
Capacity (Using 22-25 students/classroom)	850	768	828	2,446
SPED Classroom	240	50	60	350
Total Calculated Capacity	1,090	818	888	2,796
Proposed Enrollments	815	800	800	2,415
Delta (Additional Capacity)	275	18	88	381

PROGRAM

EDUCATION/PROGRAM NEEDS ASSESSMENT
 SUMMARY OF PROPOSED SPACE UTILIZATION

“Building a diverse learning community by encouraging students to open their eyes to explore, their minds to create, and their hearts to accept.”

1. SPED-Bridges/Project Achievement stay at Elm St or New MS
2. Capacity of Renovated Elm and New MS are nearly the same
 - Calculated Capacity: 1050
 - Proposed Enrollment: 815
3. Fairgrounds
 - Calculated Capacity: 818
 - Proposed Enrollment: 800
4. Pennichuck
 - Calculated Capacity: 888
 - Proposed Enrollment: 800
5. All Middle Schools have the same UA programs
6. All Middle Schools have team areas



CONCEPT

“Building a diverse learning community by encouraging students to open their eyes to explore, their minds to create, and their hearts to accept.”

OPTIONS OVERVIEW

ELM STREET MIDDLE SCHOOL RENOVATIONS AND ADDITIONS

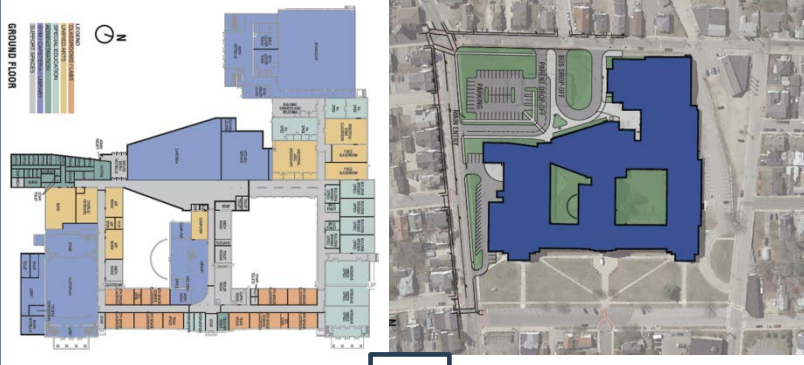

OR

NEW MIDDLE SCHOOL

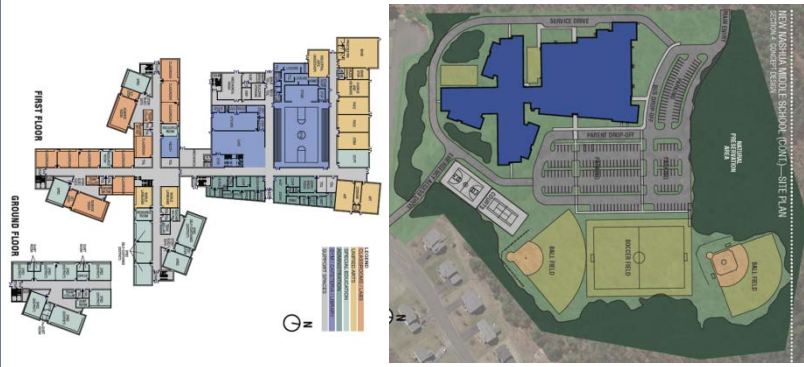

AND

FAIRGROUNDS MIDDLE SCHOOL RENOVATIONS AND ADDITION

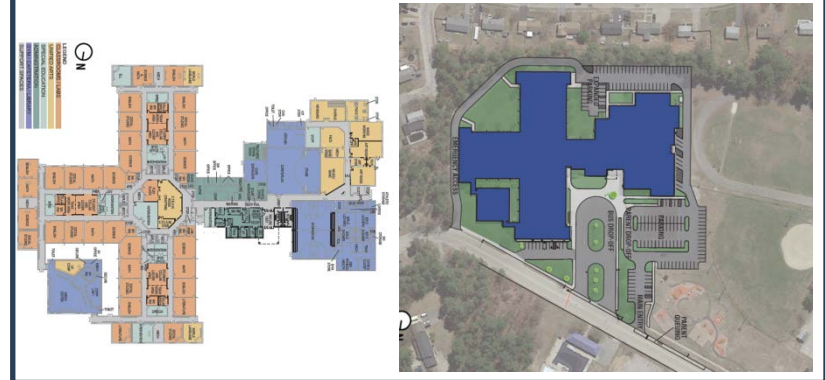

PENNICHUCK MIDDLE SCHOOL RENOVATIONS AND ADDITIONS

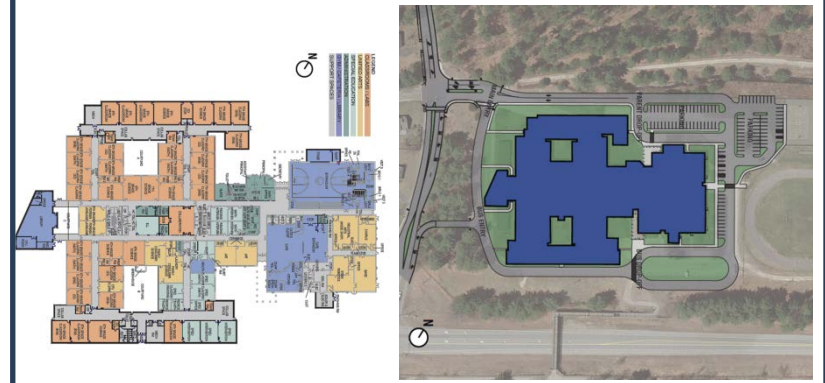

CONCEPT

CONCEPT OPTIONS
OVERVIEW

"Building a diverse learning community by encouraging students to open their eyes to explore, their minds to create, and their hearts to accept."

-
- A. Removal of portables
 - B. Single secure entrance location
 - C. Additional off-street parking
 - D. Reconfigured Drop-off at Entry Bus Loop
 - E. On-site dedicated parent drop lane

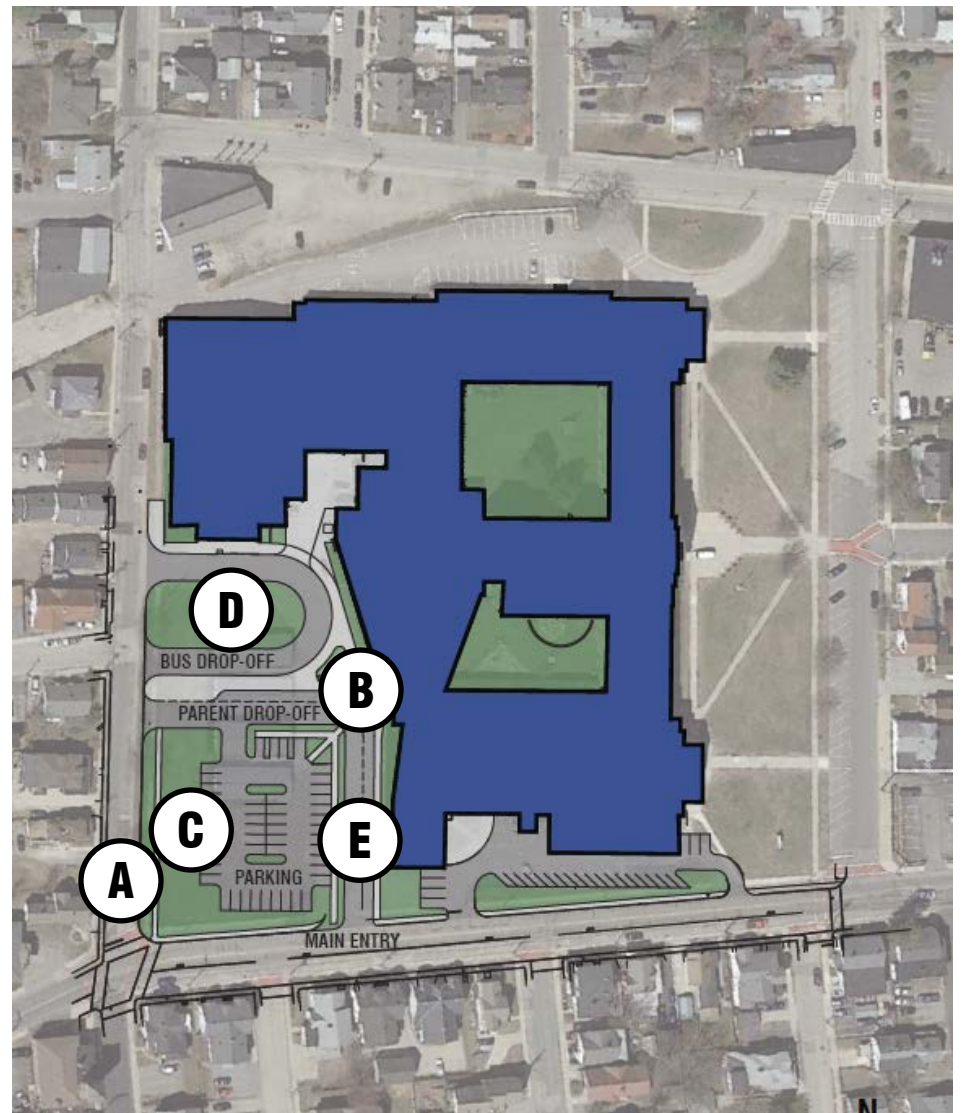

CONCEPT

CONCEPT OPTIONS
ELM STREET MIDDLE SCHOOL

“Building a diverse learning community by encouraging students to open their eyes to explore, their minds to create, and their hearts to accept.”

- A. Secure Entrance
- B. New relocated Administration Area
- C. New Cafeteria / Kitchen
- D. Updated SPED Classrooms
- E. Modified / Updated UA Classrooms
- F. Team Collaborative Instruction Spaces
- G. Resized Classroom spaces

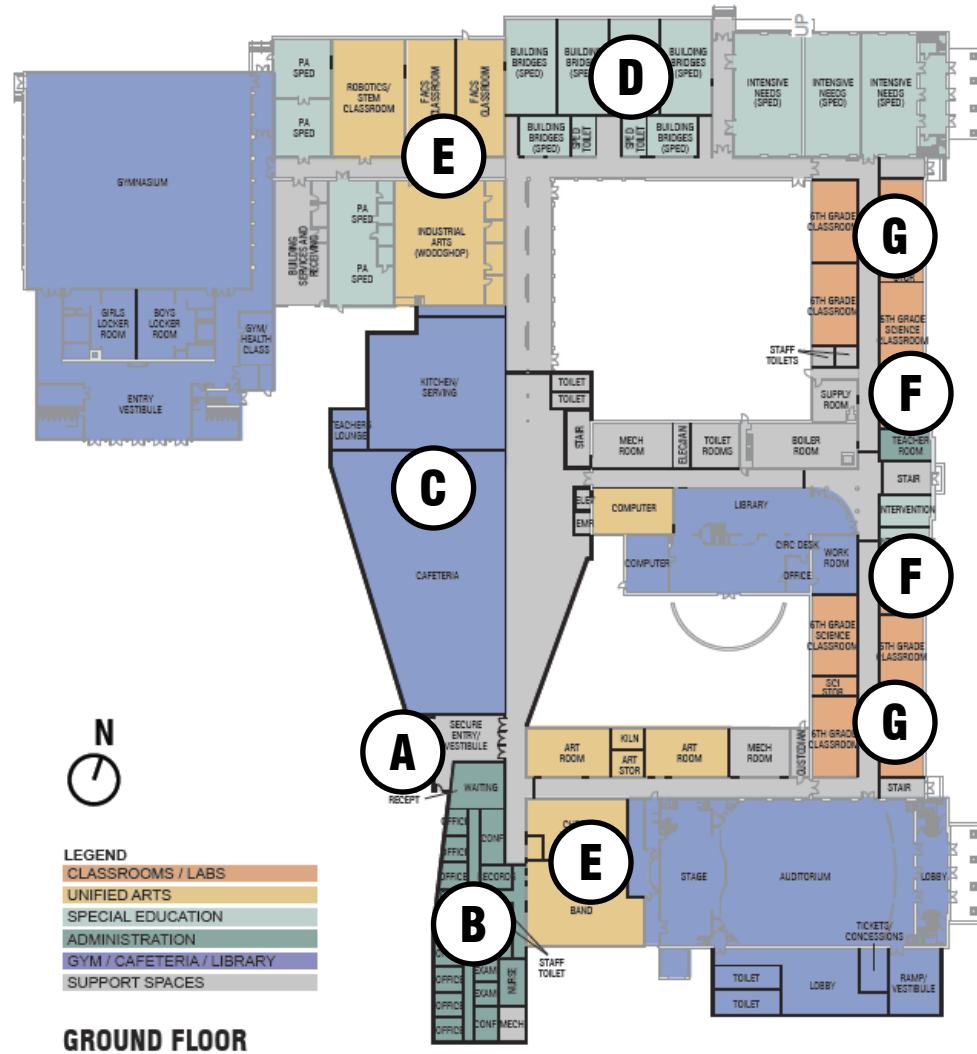

CONCEPT

CONCEPT OPTIONS ELM STREET MIDDLE SCHOOL

“Building a diverse learning community by encouraging students to open their eyes to explore, their minds to create, and their hearts to accept.”

- A. Secure Entrance
- B. New relocated Administration Area
- C. New Cafeteria / Kitchen
- D. Updated SPED Classrooms
- E. Modified / Updated UA Classrooms
- F. Team Collaborative Instruction Spaces
- G. Resized Classroom spaces

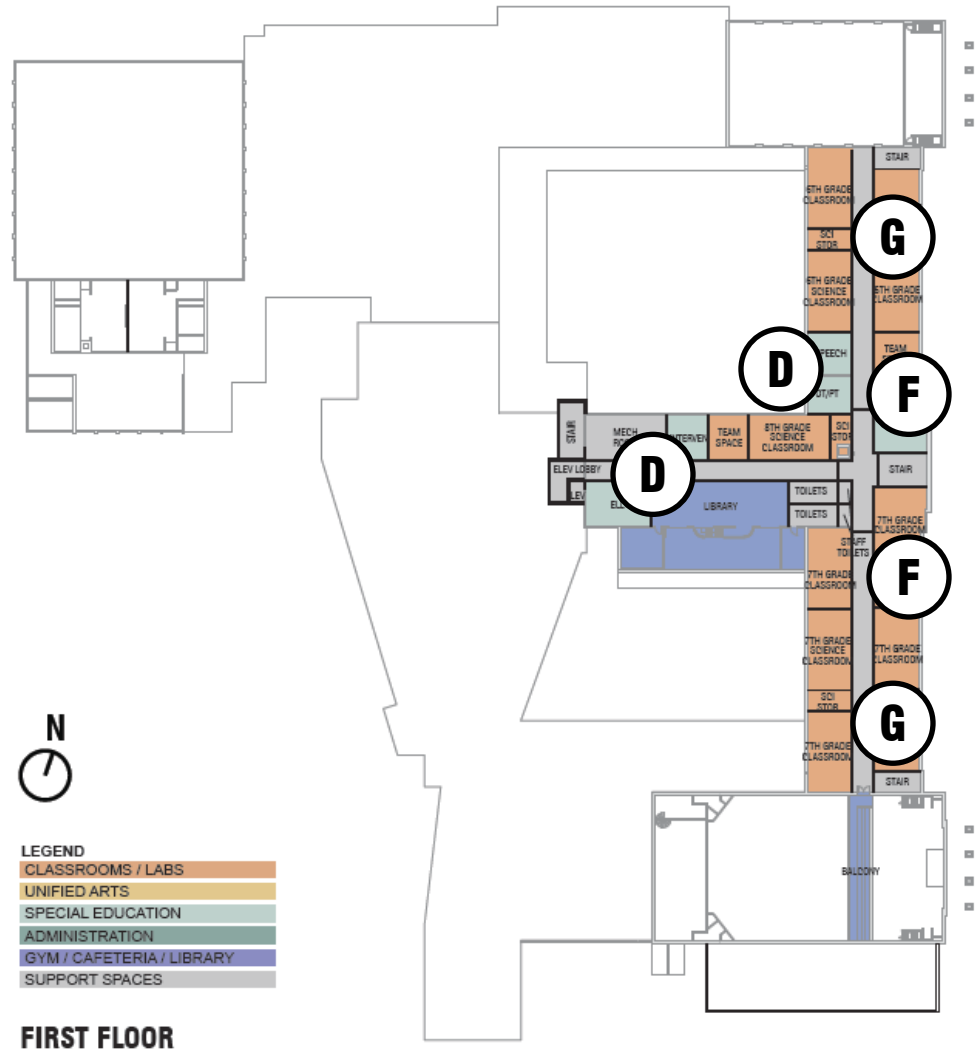

CONCEPT

CONCEPT OPTIONS ELM STREET MIDDLE SCHOOL

"Building a diverse learning community by encouraging students to open their eyes to explore, their minds to create, and their hearts to accept."

- A. Secure Entrance
- B. New relocated Administration Area
- C. New Cafeteria / Kitchen
- D. Updated SPED Classrooms
- E. Modified / Updated UA Classrooms
- F. Team Collaborative Instruction Spaces
- G. Resized Classroom spaces



LEGEND

CLASSROOMS / LABS
UNIFIED ARTS
SPECIAL EDUCATION
ADMINISTRATION
GYM / CAFETERIA / LIBRARY
SUPPORT SPACES

SECOND FLOOR

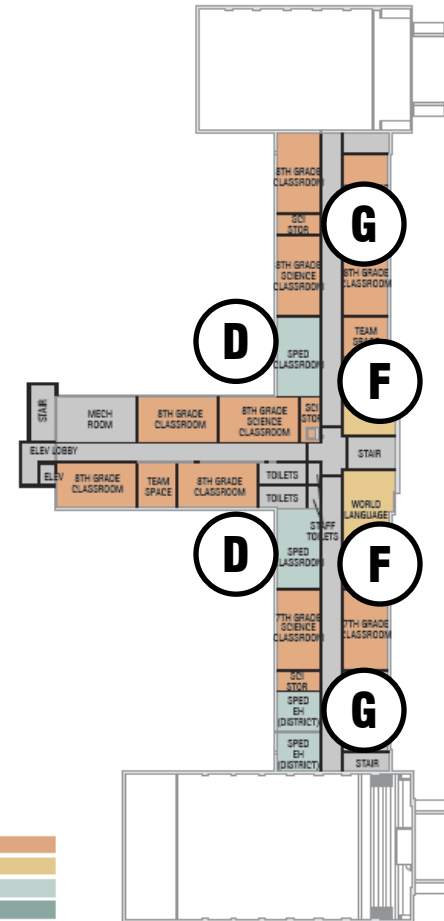

CONCEPT

CONCEPT OPTIONS ELM STREET MIDDLE SCHOOL

“Building a diverse learning community by encouraging students to open their eyes to explore, their minds to create, and their hearts to accept.”

- A. Secure Entrance
- B. New relocated Administration Area
- C. New Cafeteria / Kitchen
- D. Updated SPED Classrooms
- E. Modified / Updated UA Classrooms
- F. Team Collaborative Instruction Spaces
- G. Resized Classroom spaces



LEGEND

CLASSROOMS / LABS
UNIFIED ARTS
SPECIAL EDUCATION
ADMINISTRATION
GYM / CAFETERIA / LIBRARY
SUPPORT SPACES

THIRD FLOOR

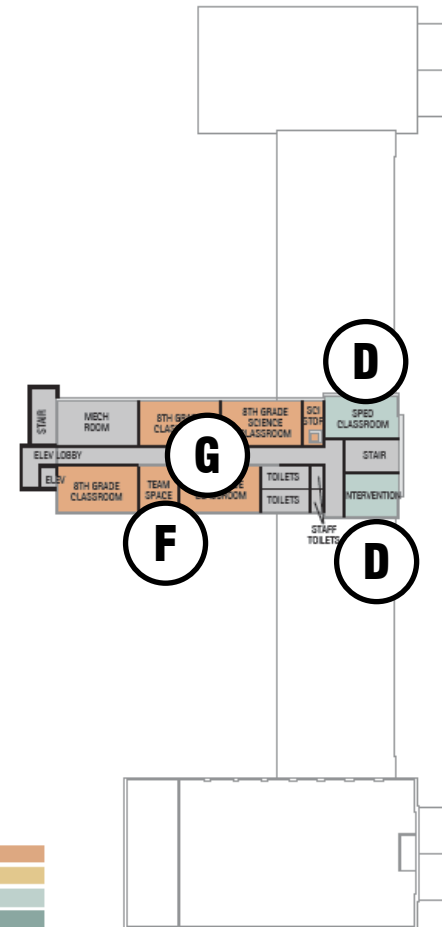

CONCEPT

CONCEPT OPTIONS ELM STREET MIDDLE SCHOOL

“Building a diverse learning community by encouraging students to open their eyes to explore, their minds to create, and their hearts to accept.”

-
- A. Perimeter Security Drive Upgraded
 - B. Additional Parking on South Side
 - C. Reconfigured Drop-off at Entry/Expanded Bus Loop
 - D. On Street Queuing Lane
 - E. Reconfigured Parking at Entry Lot

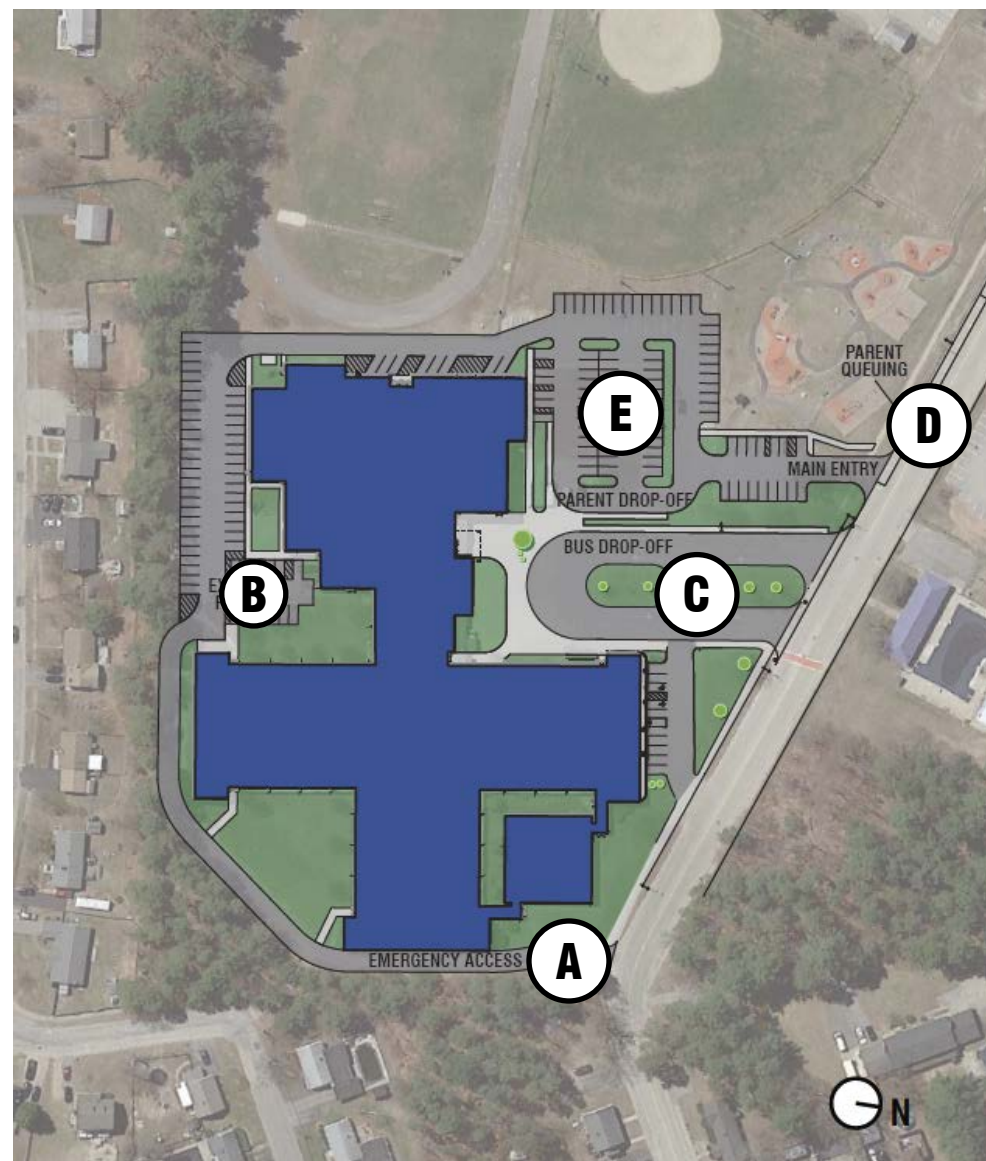

CONCEPT

.....

CONCEPT OPTIONS FAIRGROUNDS MIDDLE SCHOOL

“Building a diverse learning community by encouraging students to open their eyes to explore, their minds to create, and their hearts to accept.”

- A. New Admin and Secure Entrance
- B. Upgrades to Unified Arts
- C. Science Room Upgrades
- D. Team Collaborative Instruction Spaces
- E. Gymnasium Upgrades
- F. Upgrades to Special Education Rooms
- G. Limited System Upgrades (Electrical / Mechanical / Fire Alarm)

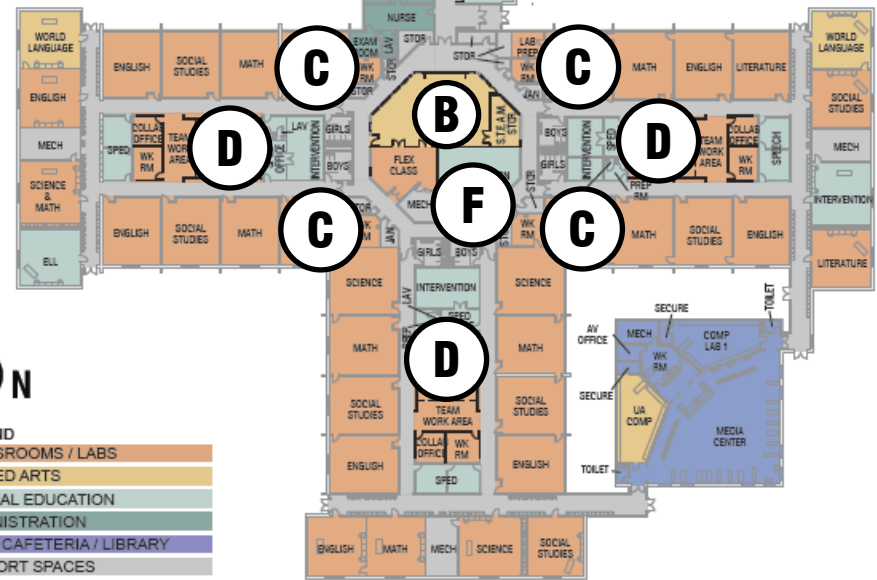
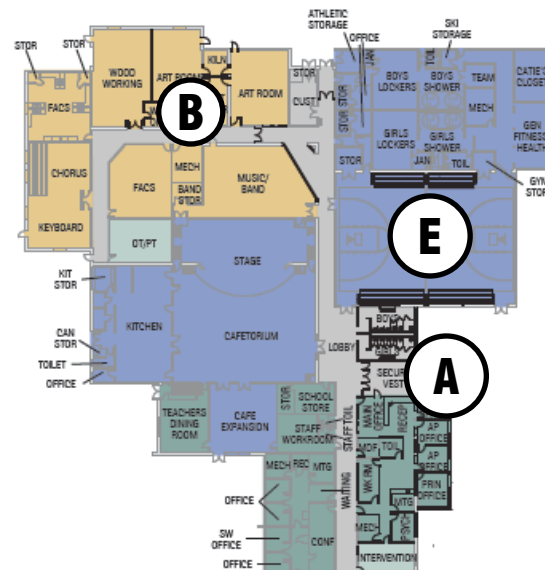

LEGEND

CLASSROOMS / LABS
UNIFIED ARTS
SPECIAL EDUCATION
ADMINISTRATION
GYM / CAFETERIA / LIBRARY
SUPPORT SPACES

CONCEPT

CONCEPT OPTIONS FAIRGROUNDS MIDDLE SCHOOL

"Building a diverse learning community by encouraging students to open their eyes to explore, their minds to create, and their hearts to accept."

- A. Removal of Portable Classrooms
- B. Classroom Additions
- C. Reconfigured Parking
- D. New Bus Drop-off
- E. New Parent Drop-off
- F. Traffic Signal at Manchester/Ferry Road
- G. Additional Entry for Buses/Emergency Access
- H. Separation Median at Entry
- I. Right and Left Exit Lane
- J. Entry Turning Lane on Manchester
- K. Improved Pedestrian Crossing

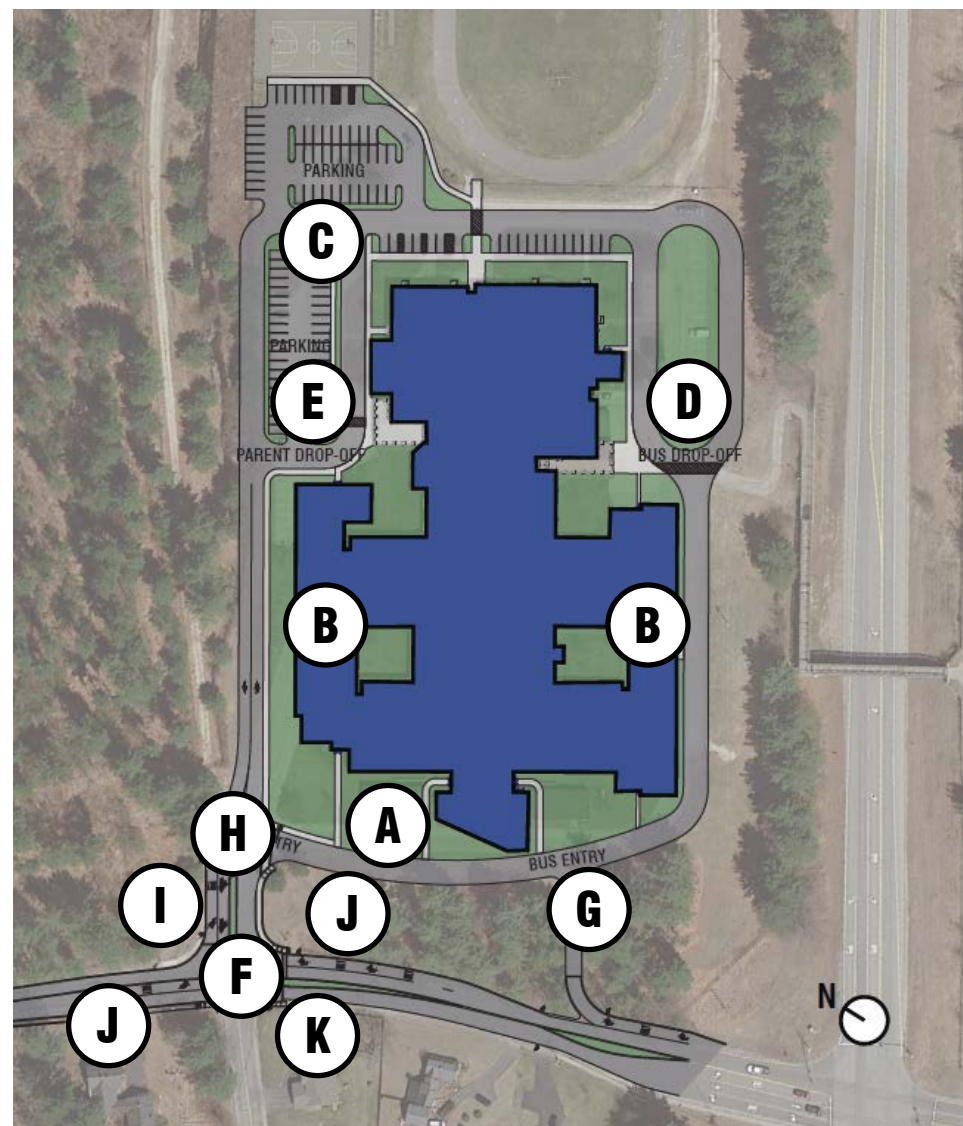

CONCEPT

CONCEPT OPTIONS
 PENNICHUCK MIDDLE SCHOOL

“Building a diverse learning community by encouraging students to open their eyes to explore, their minds to create, and their hearts to accept.”

- A. Classroom Additions to Replace Portables, Increase Capacity
- B. Library Addition
- C. Upgrades to Unified Arts
- D. Science Room Upgrades
- E. Team Collaborative Instruction Spaces
- F. Gymnasium Upgrades, Stage addition
- G. Upgrades to Special Education Rooms
- H. Cafeteria expansion

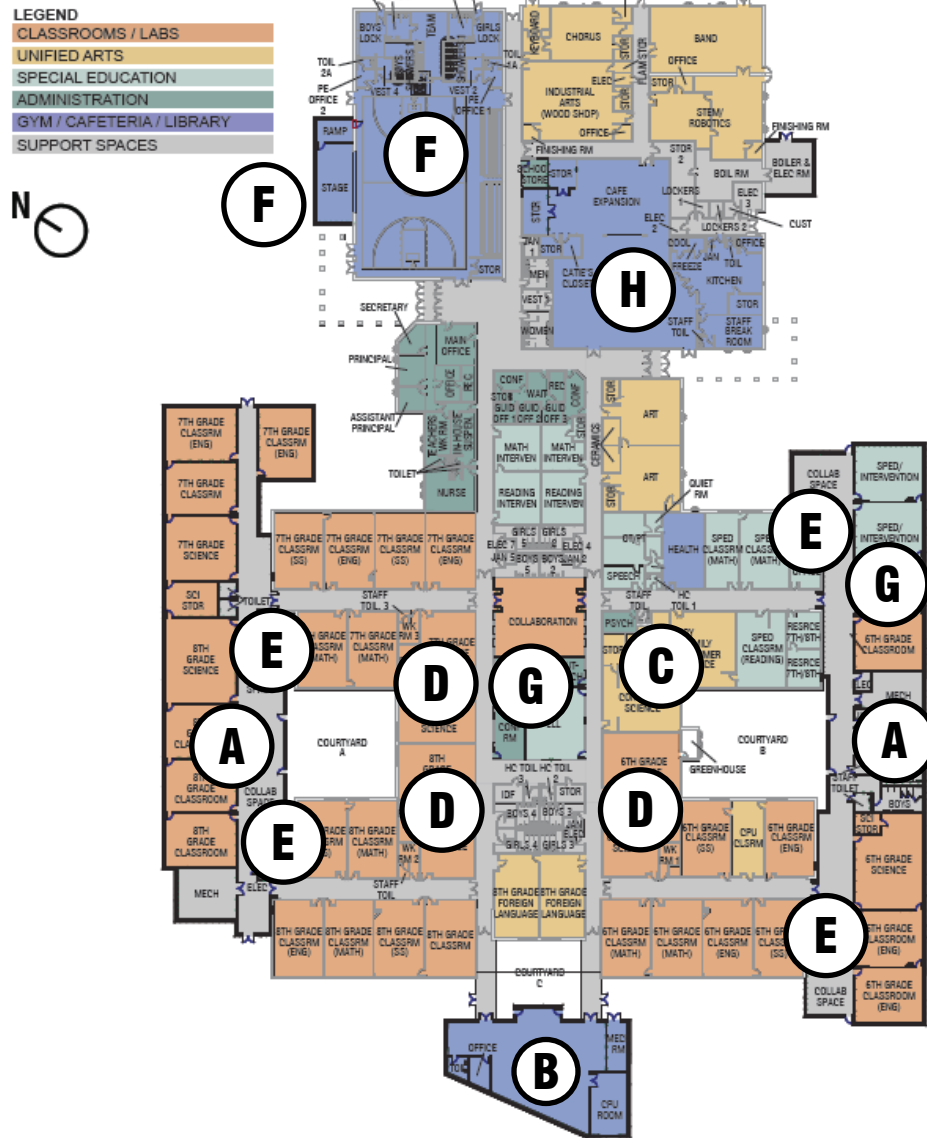

CONCEPT

CONCEPT OPTIONS PENNICHUCK MIDDLE SCHOOL

"Building a diverse learning community by encouraging students to open their eyes to explore, their minds to create, and their hearts to accept."

- A. 20 Acre Site Development
- B. On site Parking Spaces
- C. Recreational Play fields and Courts
- D. Natural Preservation Area
- E. Connection to Trail Network
- F. Access Drive from Buckmeadow
- G. Emergency Access from Cherrywood
- H. Water/Sewer from Cherrywood
- I. New upgraded power from Buckmeadow
- J. Sidewalk to site from Buckmeadow
- K. Dedicated Service and Emergency Drive
- L. Dedicated safe SPED play area

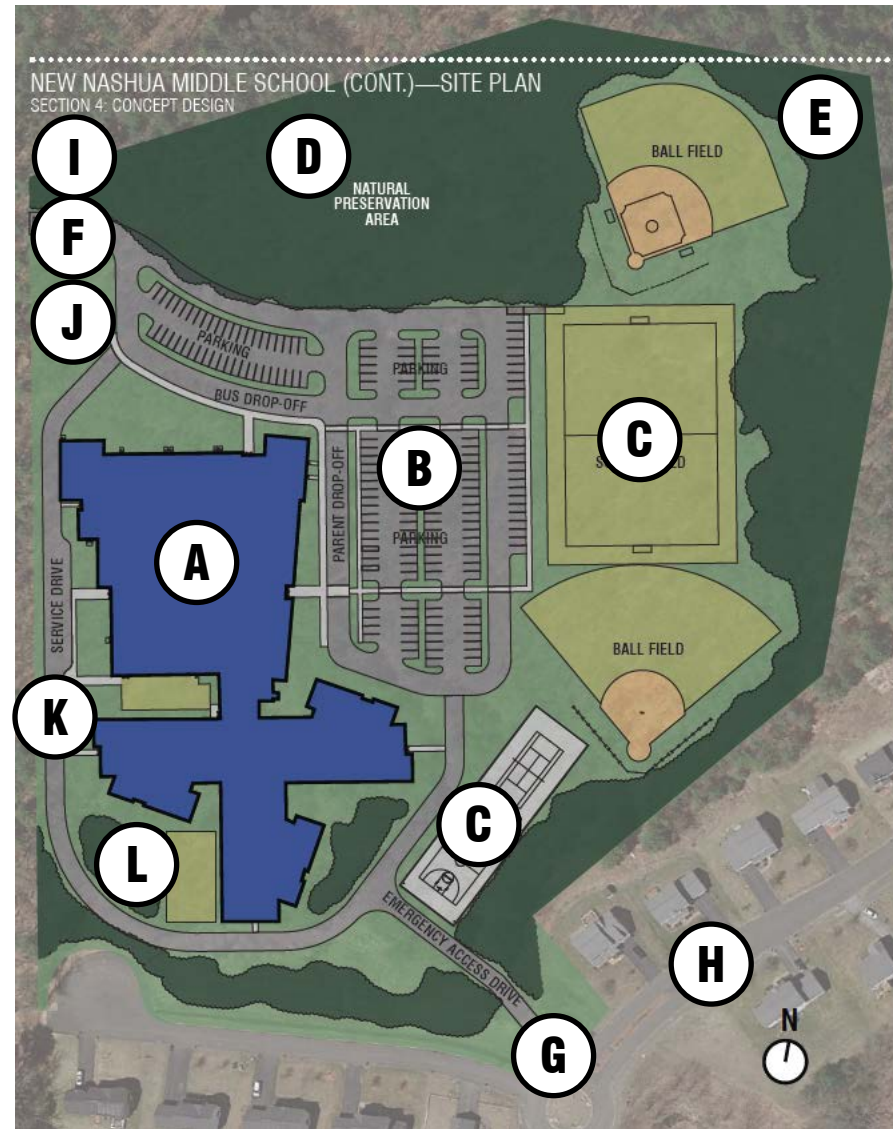

CONCEPT

CONCEPT OPTIONS NEW MIDDLE SCHOOL

“Building a diverse learning community by encouraging students to open their eyes to explore, their minds to create, and their hearts to accept.”

- A. Secure Entrance
- B. Innovative MS Classroom Communities
- C. Ability to Close off Public Spaces for After School Activities/Community Access
- D. 21st Century Unified Arts/STEM Spaces
- E. Enhanced SPED spaces
- F. Administration, Nurse, Guidance
- G. Gym, Performance space, Café, Library
- H. Possible Future Addition Locations

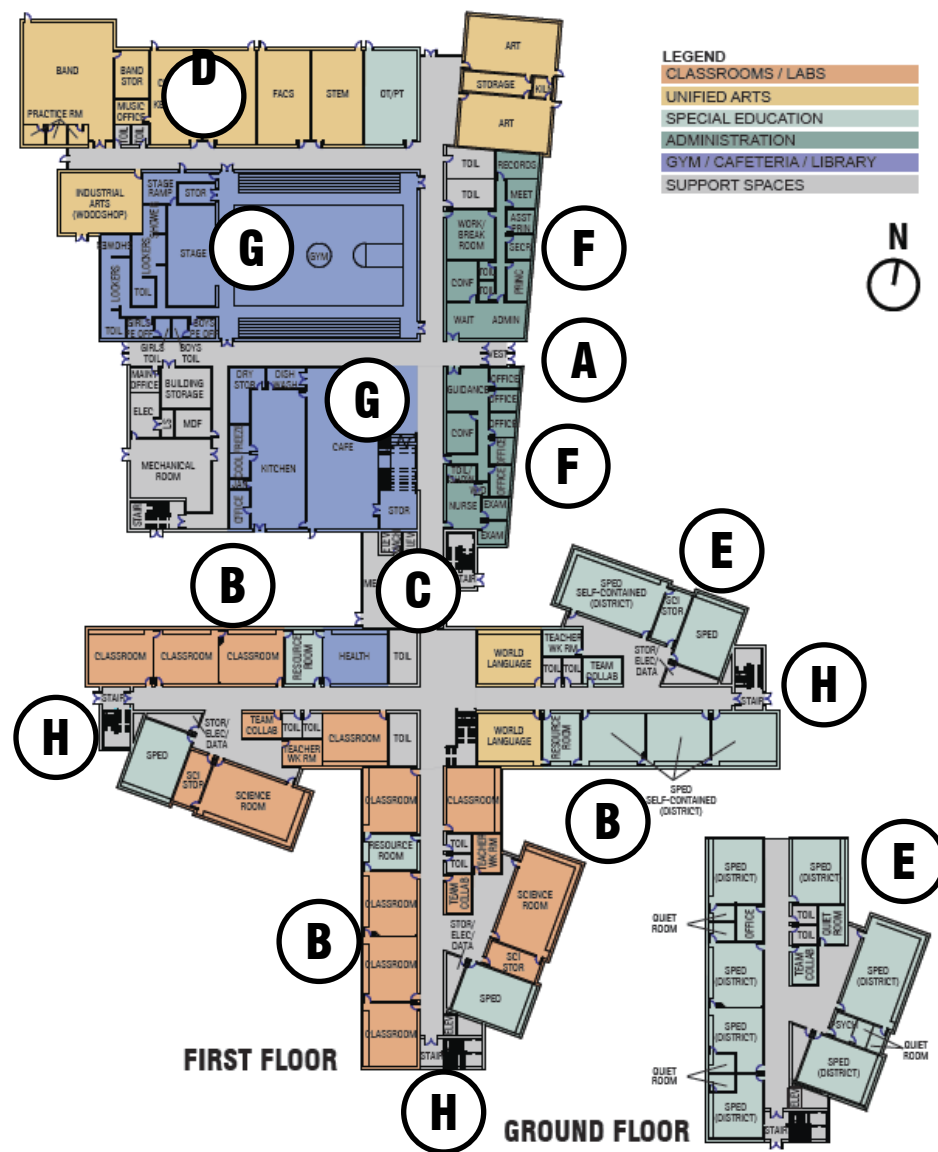

CONCEPT

CONCEPT OPTIONS NEW MIDDLE SCHOOL

"Building a diverse learning community by encouraging students to open their eyes to explore, their minds to create, and their hearts to accept."

LEGEND	
	CLASSROOMS / LABS
	UNIFIED ARTS
	SPECIAL EDUCATION
	ADMINISTRATION
	GYM / CAFETERIA / LIBRARY
	SUPPORT SPACES



- A. Secure Entrance
- B. Innovative MS Classroom Communities
- C. Ability to Close off Public Spaces for After School Activities/Community Access
- D. 21st Century Unified Arts/STEM Spaces
- E. Enhanced SPED spaces
- F. Administration, Nurse, Guidance
- G. Gym, Performance space, Café, Library
- H. Possible Future Addition Locations

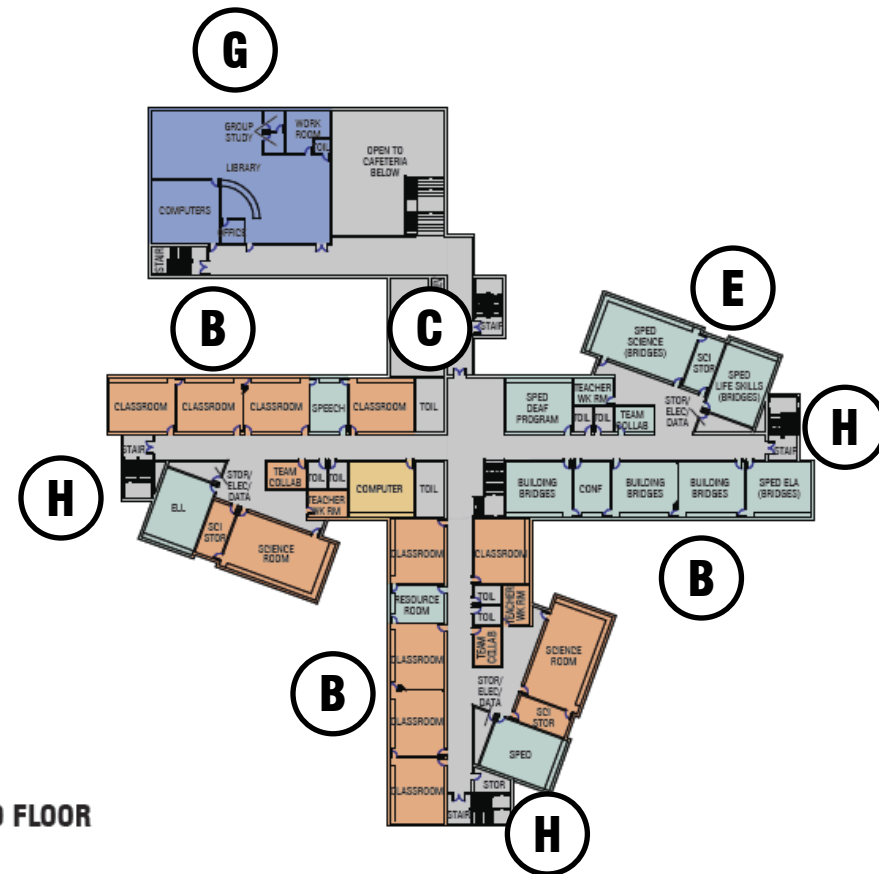

CONCEPT

CONCEPT OPTIONS NEW MIDDLE SCHOOL

“Building a diverse learning community by encouraging students to open their eyes to explore, their minds to create, and their hearts to accept.”

LEGEND	
	CLASSROOMS / LABS
	UNIFIED ARTS
	SPECIAL EDUCATION
	ADMINISTRATION
	GYM / CAFETERIA / LIBRARY
	SUPPORT SPACES

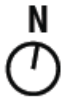

- A. Secure Entrance
- B. Innovative MS Classroom Communities
- C. Ability to Close off Public Spaces for After School Activities/Community Access
- D. 21st Century Unified Arts/STEM Spaces
- E. Enhanced SPED spaces
- F. Administration, Nurse, Guidance
- G. Gym, Performance space, Café, Library
- H. Possible Future Addition Locations

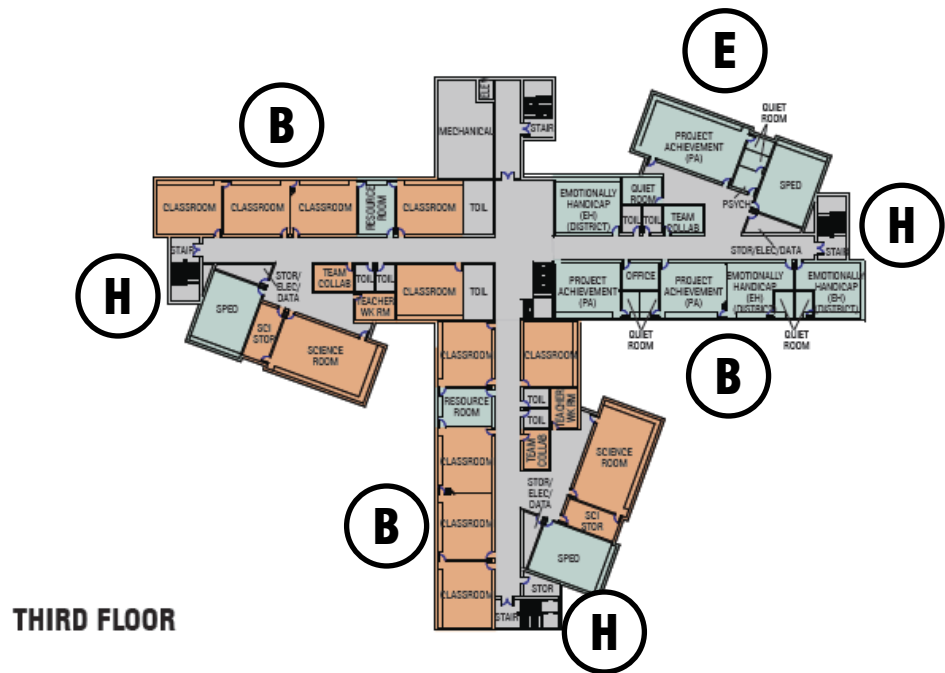

CONCEPT

CONCEPT OPTIONS NEW MIDDLE SCHOOL

“Building a diverse learning community by encouraging students to open their eyes to explore, their minds to create, and their hearts to accept.”



SCHEDULE

ELM STREET MIDDLE SCHOOL

- Anticipated Construction Start – Winter 2021
- Anticipated Construction Duration – 48 Months

FAIRGROUNDS MIDDLE SCHOOL

- Anticipated Construction Start – Summer 2020
- Anticipated Construction Duration – 11 Months

PENNICHUCK MIDDLE SCHOOL

- Anticipated Construction Start – Summer 2020
- Anticipated Construction Duration – 14 Months

NEW MIDDLE SCHOOL

- Anticipated Construction Start – Winter 2021 (Partial Site Clearing – Spring 2020)
- Anticipated Construction Duration – 24 Months

.....
ANTICIPATED SCHEDULE SUMMARY

HARRIMAN

